

PR and PKR Actuators with 3-Way Butterfly Valves

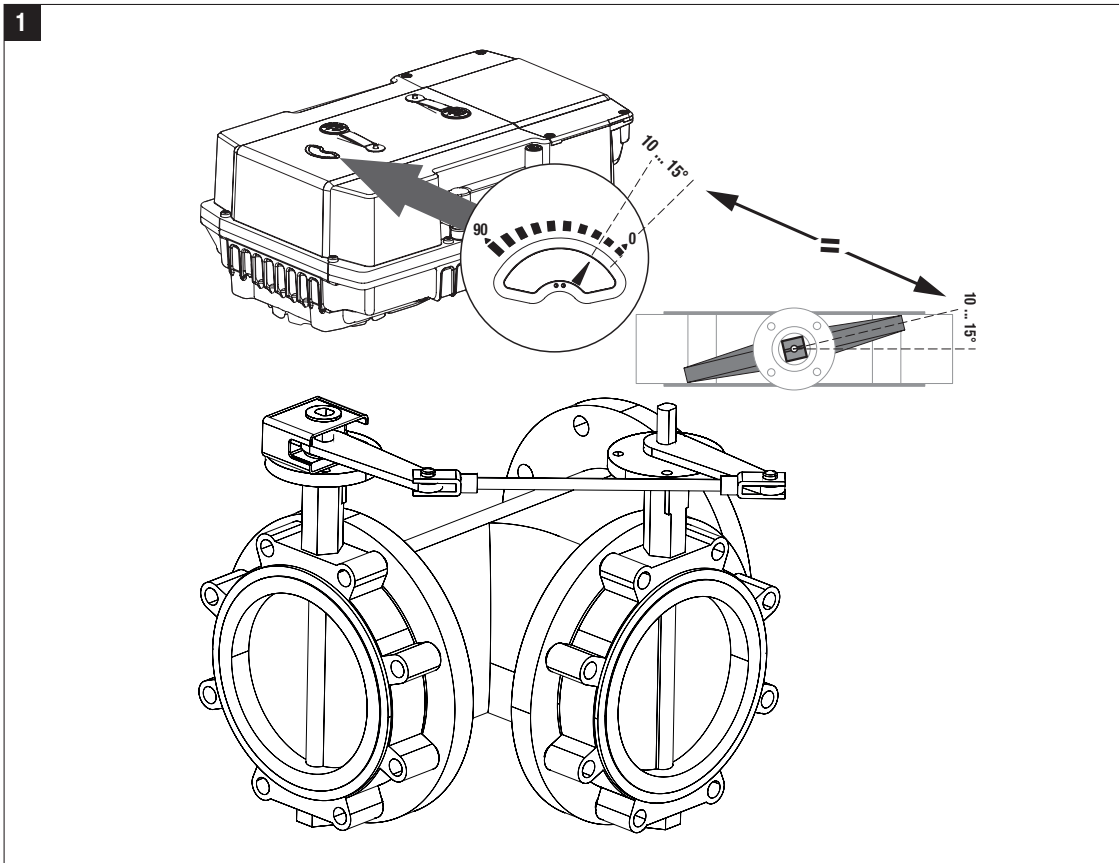

PR and PKR Actuators with 3-Way Butterfly Valves

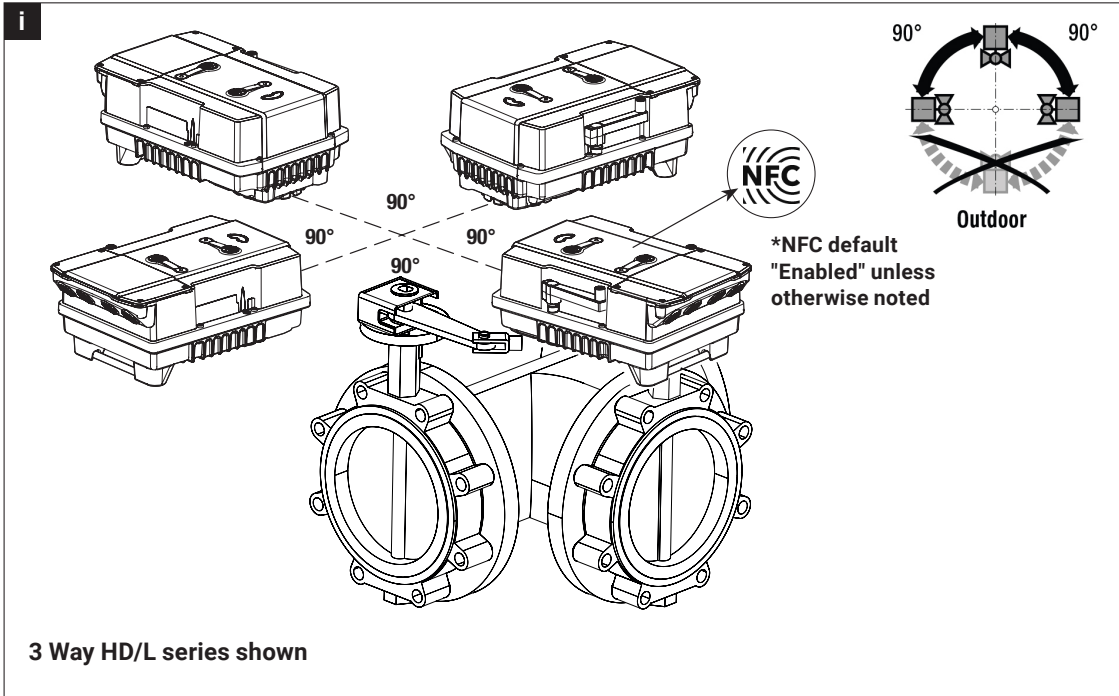
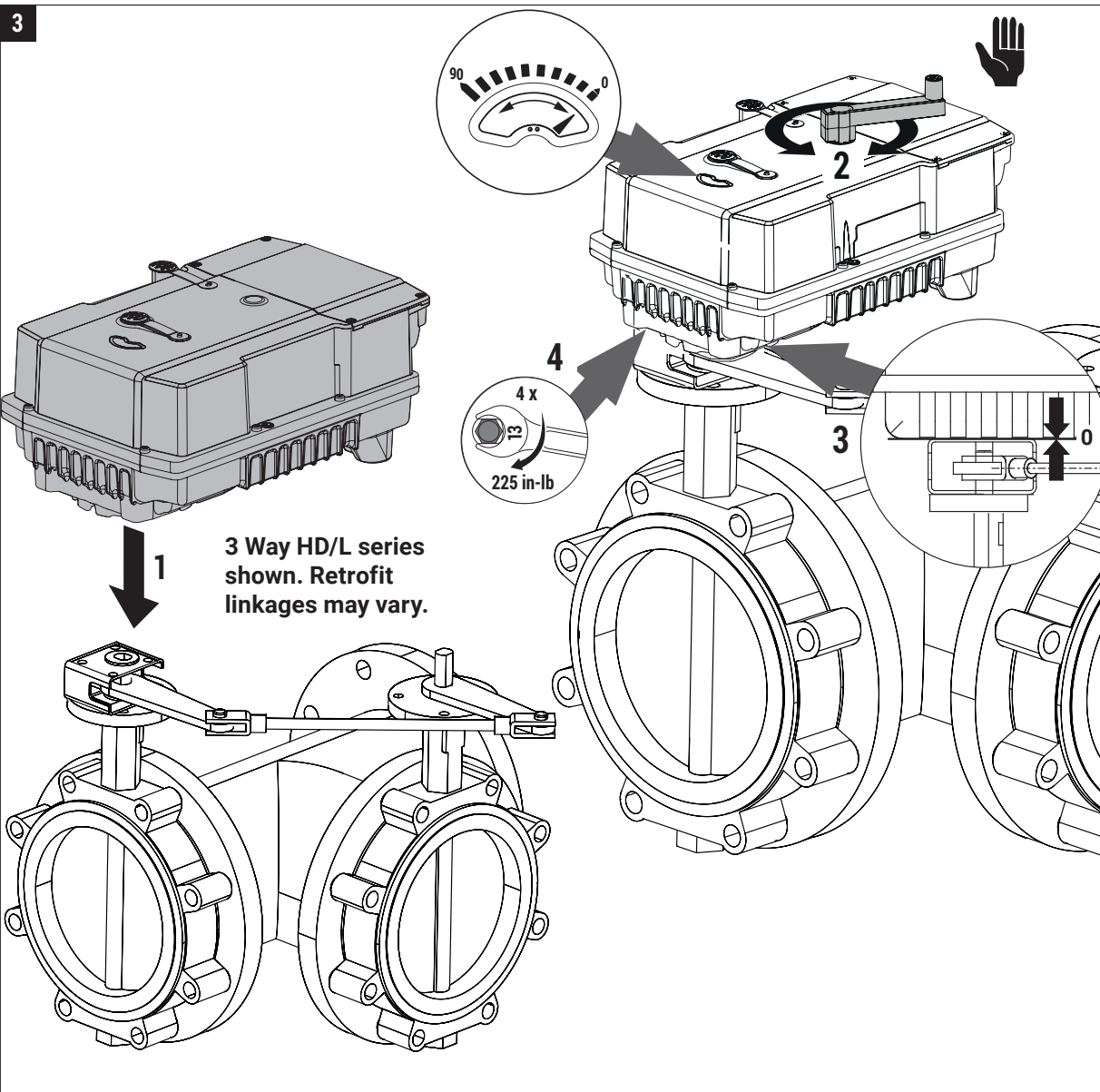
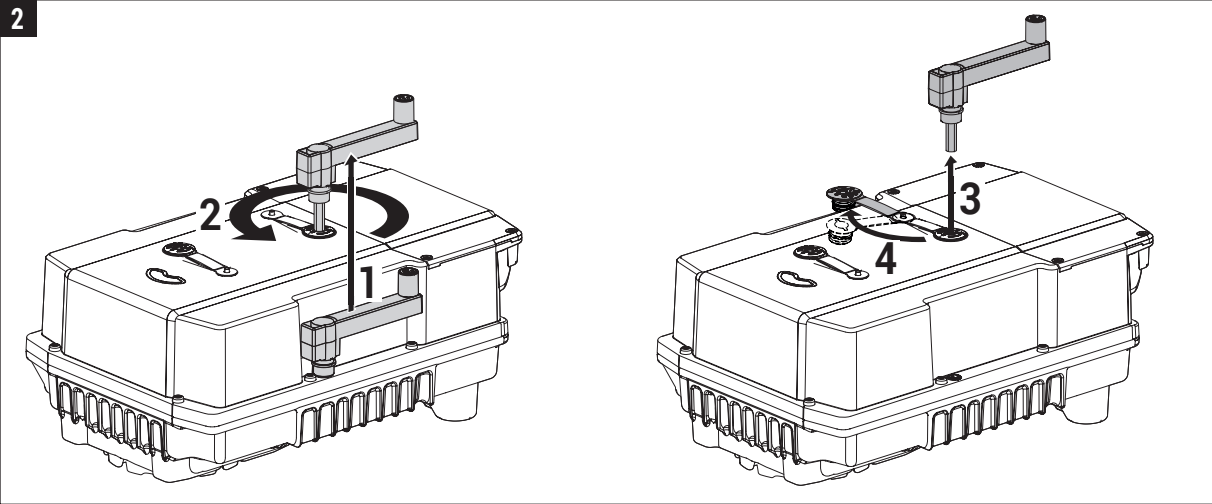

3 Way HD/L series
shown. Retrofit
linkages may vary.

PR and PKR Actuators with 3-Way Butterfly Valves

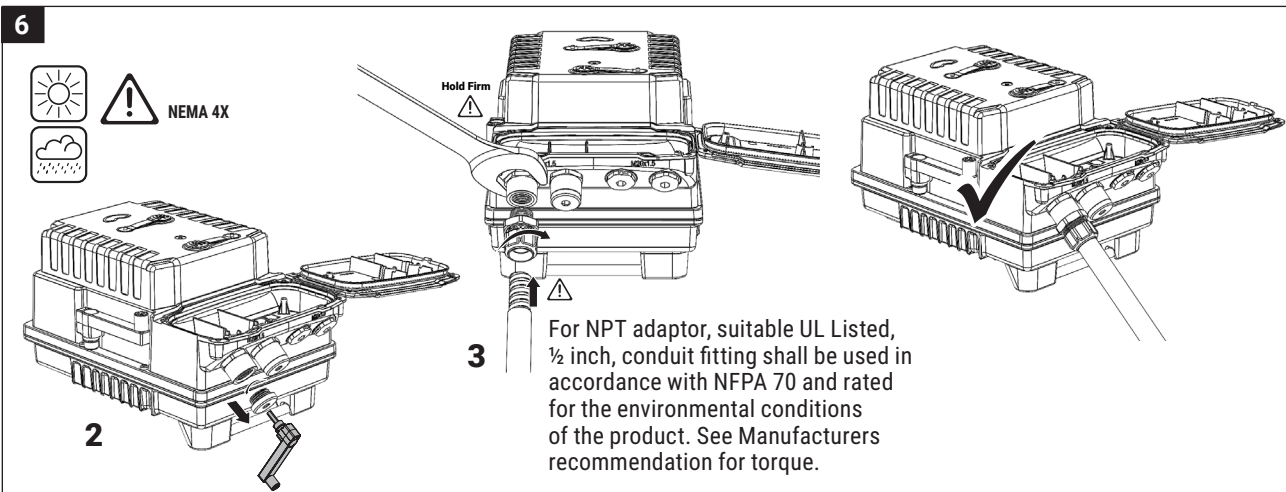
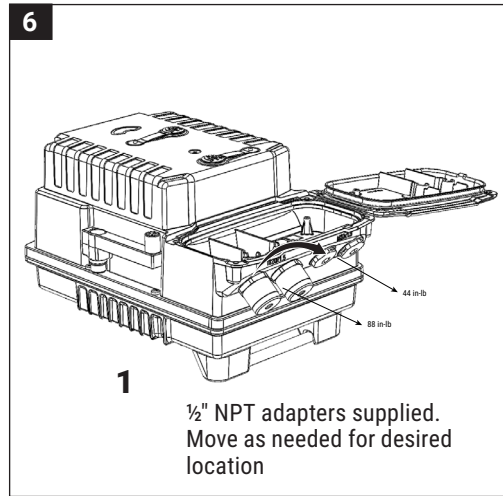
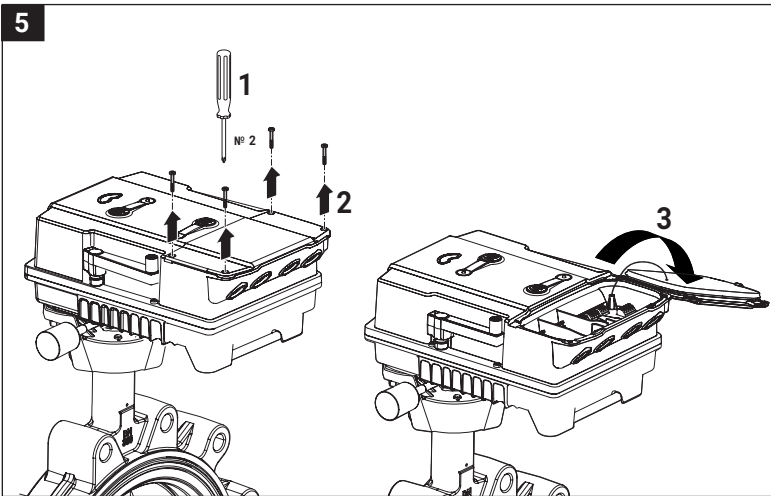
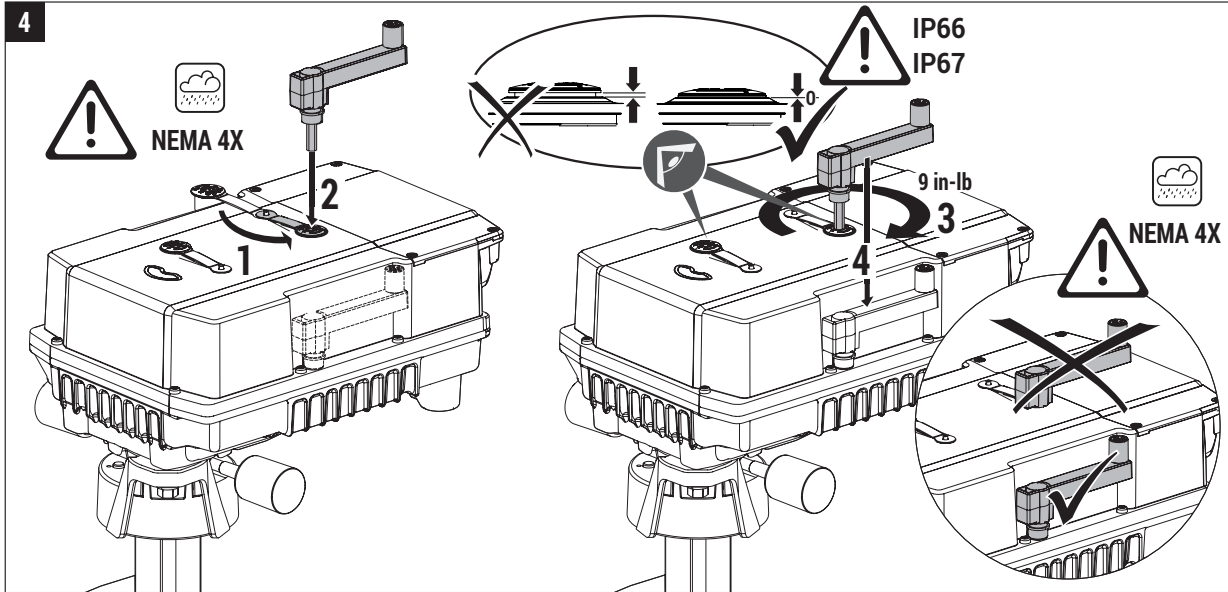

PR and PKR Actuators with 3-Way Butterfly Valves

7

8

NEMA 4X

1 12 in.-lb
N#2

2 NEMA 4X

3

4 0%

WARNING: The wiring technician must be trained and experienced with electronic circuits. Disconnect power supply before attempting any wiring connections or changes. Make all connections in accordance with wiring diagrams and follow all applicable local and national codes. Provide disconnect and overload protection as required. Use copper, twisted pair, conductors only. If using electrical conduit, the attachment to the actuator must be made with flexible conduit.

WIRING DIAGRAMS

PR and PKR Actuators

On/Off

Floating Point

On/Off

VDC / 4 to 20 mA

Notes:

- ◆ Meets cULus requirements without the need of an electrical ground connection.
- ⚠ Provide overload protection and disconnect as required.
- ⚠ Only connect common to neg. (-) leg of control circuits.
- ⚠ Two built-in auxiliary switches (2x SPDT), for end position indication, interlock control, fan startup, etc.
- ⚠ Actuators may be controlled in parallel. Current draw and input impedance must be observed
- ⚠ Universal Power Supply (UP) models can be supplied with 24 VAC up to 240 VAC, or 24 VDC up to 125 VDC.
- ⚠ During installation, testing, servicing and troubleshooting of this product, it may be necessary to work with live electrical components. Have a qualified licensed electrician or other individual who has been properly trained in handling live electrical components perform these tasks. Failure to follow all electrical safety precautions when exposed to live electrical components could result in death or serious injury.

****Control type, direction and fail position changes can be made via Belimo Selection Tools, i.e. ZTH, PC-Tool and App.**

Optional: end switch adjustment

Push-buttons and display

BACnet

Temp Sensor

End Switches